

MONOBLOCK-2 V3 (2)

Treatment capacity 600 L/day



Tolerated values +/-3%.

Primary treatment	Values	Units
Volume required	2000	L
Volume per PE	500	L
Secondary treatment	Values	Units
Compartment volume	1500	L
Daily volume of wastewater	150	L/day/PE
Daily hydraulic load	0,6	m/day
Organic load per PE	60	gr.BOD5/PE/day
Gross organic load	Up to 0.24	kg BOD5/day
Specifications	Values	Units
Total length	2830	mm
Length x width primary treatment	1764 x 1150	mm
Surface secondary treatment	0.82	m ²
Total width	1378	mm
Total height	2275	mm
Total weight (empty tank)	295	kg
Pipe diameter	110	mm
Pad diameter (Primary tank)	600	mm
Pad diameter (Treatment Unit)	1000	mm

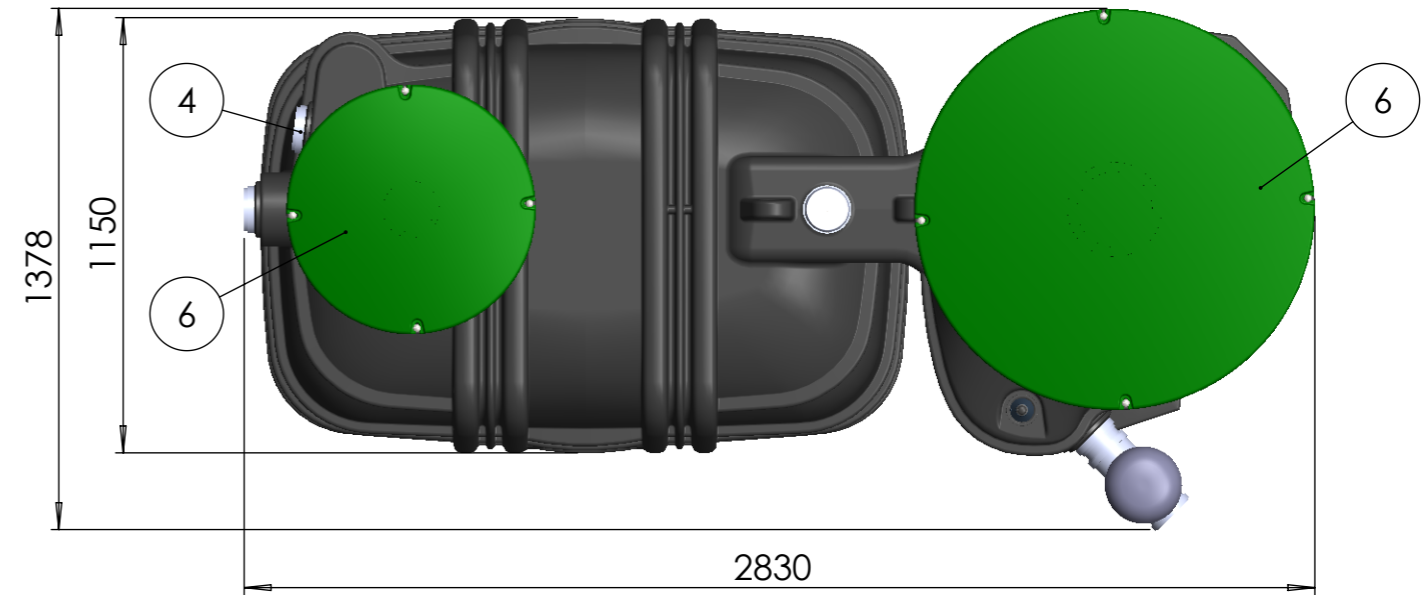
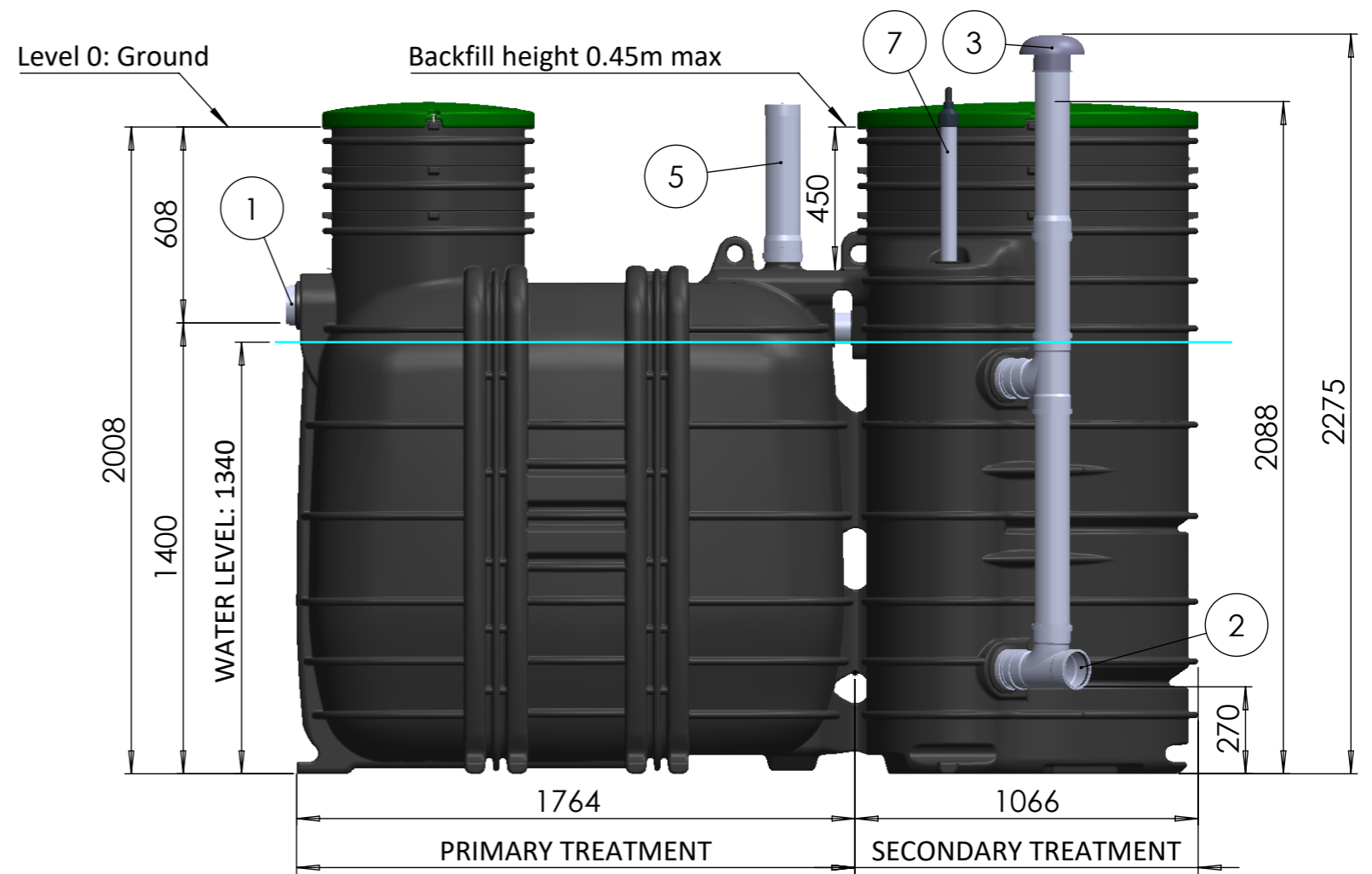

N°	Description
1	Water inlet
2	Water outlet
3	Air inlet
4	Air outlet
5	Effluent filter outlet
6	Ø600 mm and Ø1000 mm covers
7	Alarm

BIOROCK

Création	Date
NH	30/10/2023
Approbation	Date
AC	02/11/2023
Format: A3	Echelle: 1:20

Monoblock 2000 V3

Matière: / Masse: Page: 1 / 2

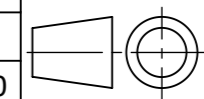

FT-0001150